

REV	DESCRIPTION	DESIGN	DATE
B	CHANGE MYLAR SIZE	PangSongle	2021/01/29
C	CHANGE MYLAR SIZE	S. Tang	2023/11/10

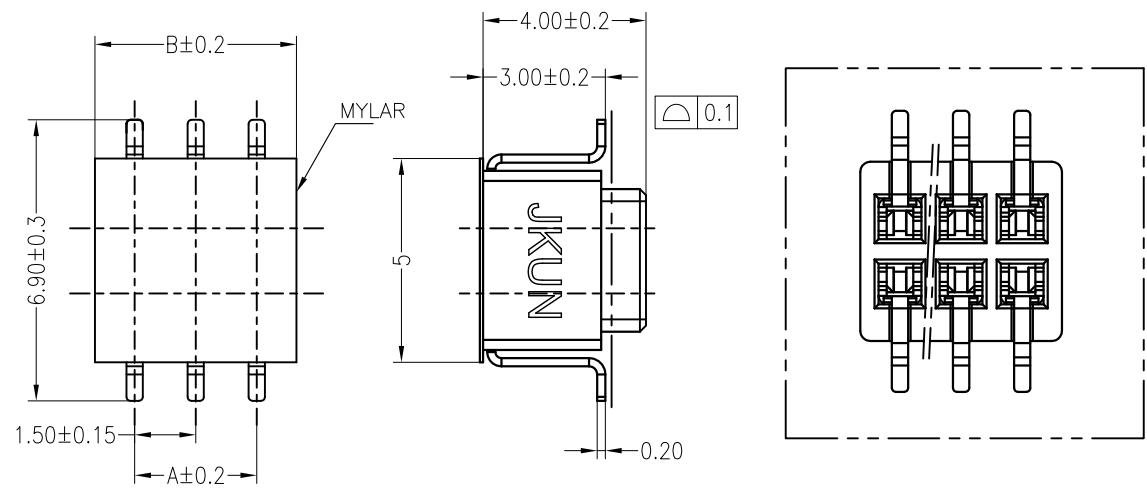

PIN.	DIM A	DIM B
2*2	1.50	3.50
2*3	3.00	5.00
2*4	4.50	6.50
2*5	6.00	8.00
2*6	7.50	9.50
2*7	9.00	11.00
2*8	10.50	12.50

**Specifications:**  
 Contact resistance:  $\leq 30m\Omega$   
 Insulation resistance:  $\geq 500M\Omega$   
 Rated voltage: 250V AC DC  
 Rated current: 1.0A AC DC  
 Withstand Voltage: 500V AC/minute  
 Temperature Range:  $-40^{\circ}C \sim +110^{\circ}C$   
 Housing: LCP UL94V-0, Natural (Beige)  
 Contacts: Phosphor Bronze/Sn-plated

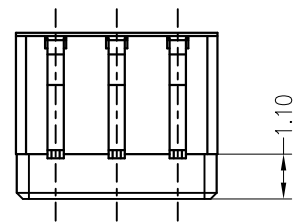

**PCB LAYOUT**

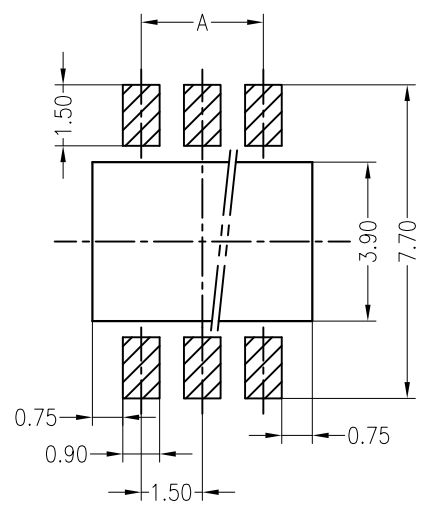
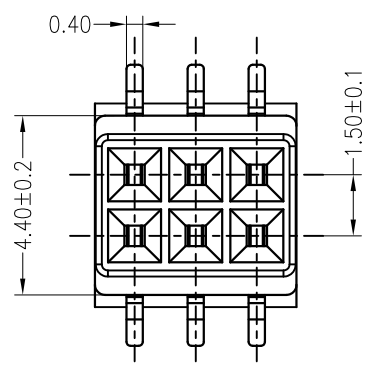

**ORDER INFORMATION:**

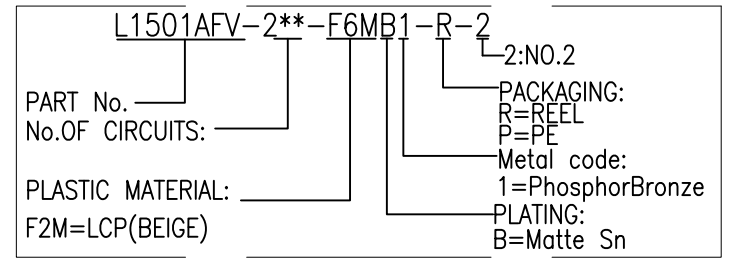

<b>JKUN</b> 温州健坤接插件有限公司 WENZHOU JKUN CONNECTOR CO.,LTD.		TITLE: L1501AFV	
GENERAL TOLERANCE		USE: CUSTOMER	PART NO.:
X.X $\pm 0.30$	X. $\pm 5^{\circ}$	APPD: 姚建军	L1501AFV-2**-F6MB1-R-2
X.XX $\pm 0.20$	X.X $\pm 2^{\circ}$	CHKD: 颜鹏	DWG NO.:
X.XXX $\pm 0.10$	X.XX $\pm 1^{\circ}$	DR: 唐硕	JKUN-GCKH-1279
UNITS: mm		SCALE 1 : 1	SHEET 1 / 1

REV	ECN No.	DESCRIPTION	DESIGN	DATE
A	-	Release	-	2018.06.11
A1		变更麦拉宽度解决抛料问题	蒋建银	2020.05.03
B		改善自动机切麦拉切不断, 麦拉容易粘编带问题	方松乐	2021.01.29

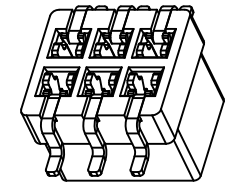
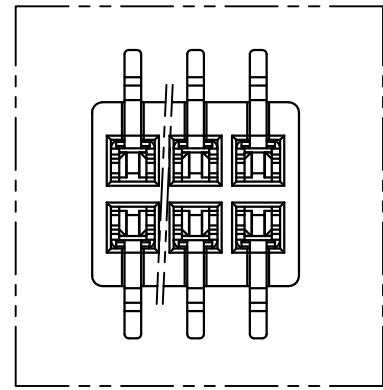
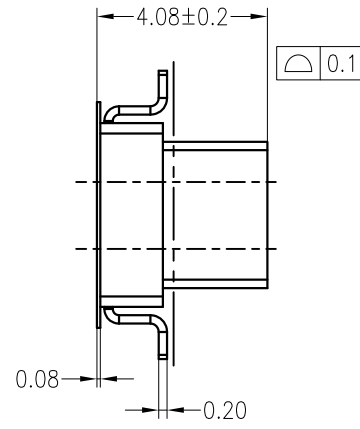
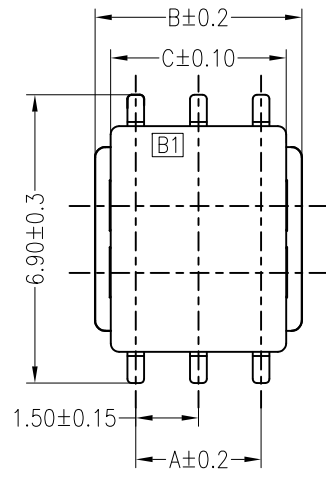

### 主要技术参数 Main Specifications

线 数 (Poles): 04 to 16  
 接触电阻 (Contact resistance):  $\leq 30m\Omega$   
 绝缘电阻 (Insulation resistance):  $\geq 500M\Omega$   
 额定电压 (Rated voltage): 250V AC DC  
 额定电流 (Rated current): 1.0A AC DC  
 耐 电 压 (Withstand Voltage): 500V AC/minute  
 温度范围 (Temperature Range):  $-40^{\circ}C \sim +110^{\circ}C$

PIN.	DIM A	DIM B	DIM C
2*2	1.50	3.50	2.65
2*3	3.00	5.00	A1 4.20
2*4	4.50	6.50	
2*5	6.00	8.00	
2*6	7.50	9.50	
2*7	9.00	11.00	
2*8	10.50	12.50	

### ORDER INFORMATION:

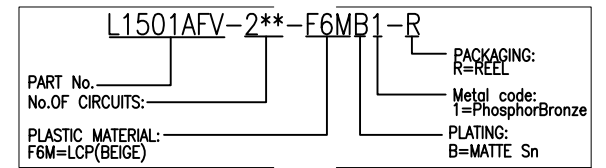

### PCB LAYOUT

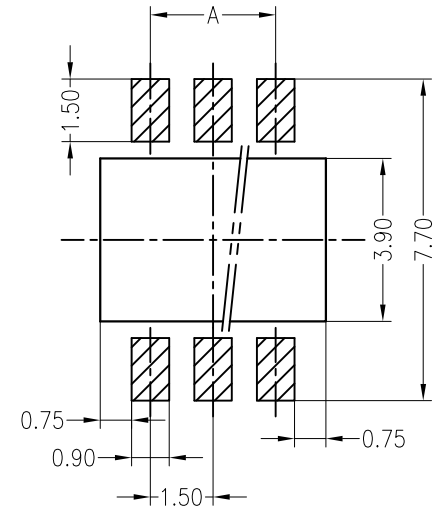
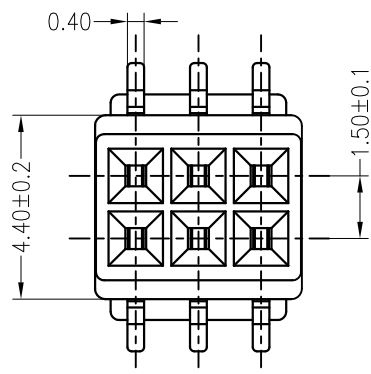
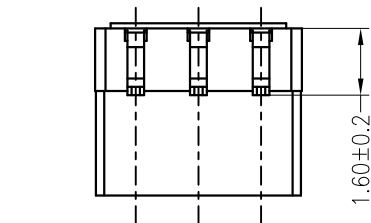

ITEM	COMPONENT	Q'TY	MATERIAL	FINISH
C	MYLAR	1 PCS		
B	CONTACT	n PCS	PhosphorBronze	Sn-plated
A	HOUSING	1 PCS	LCP	UL 94V-0, COLOR:BEIGE

**JKUN** 温州健坤接插件有限公司  
WENZHOU JKUN CONNECTOR CO., LTD.

TITLE: L1501AFV  
-

X.±0.5	X.±5'	USE:	PART NO.:
.X±0.3	.X±2'	CUSTOMER	L1501AFV-2**-F6MB1-R
.XX±0.25	.XX±1'	APPD: 邵敬和	DWG NO.:
--	--	CHKD: 田峰	JKUN-GCKH-1172
⊕	◁	DR: 蒋建银	SCALE 1:1
		UNITS: mm	SHEET 1/1

REV	DESCRIPTION	DESIGN	DATE
A	NEW RELEASE	J. Y. Jiang	2024/10/15

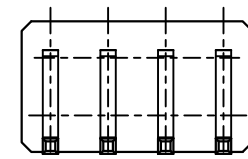
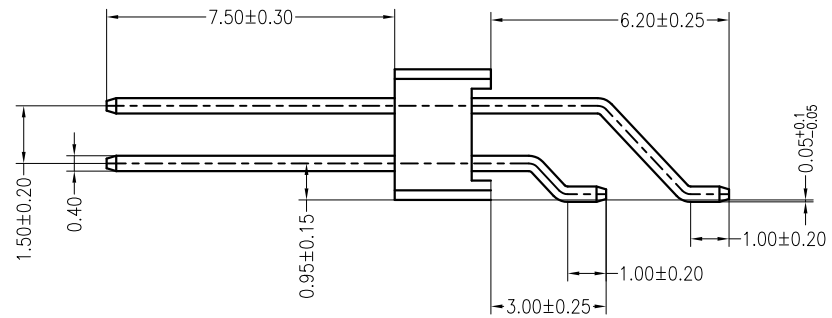
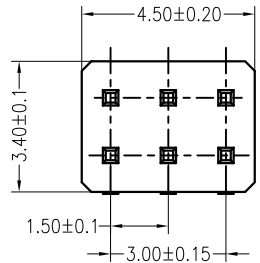

**Specifications:**

- Poles: 04 to 16
- Contact resistance:  $\leq 30m\Omega$
- Insulation resistance:  $\geq 500M\Omega$
- Rated voltage: 250V AC DC
- Rated current: 1.0A AC DC
- Withstand Voltage: 500V AC/minute
- Temperature Range:  $-40^{\circ}C \sim +110^{\circ}C$
- Housing: LCP UL94V-0, Natural (Beige)
- Contacts: Brass/Matte Sn-plated

**ORDER INFORMATION:**

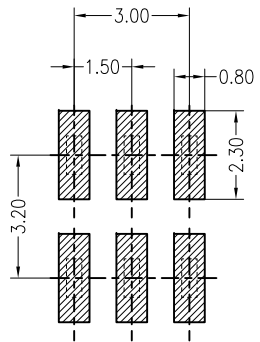
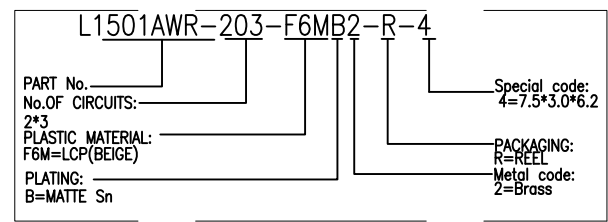

ROMMENDED PCB LAYOUT  
TOLERANCE  $\pm 0.05$

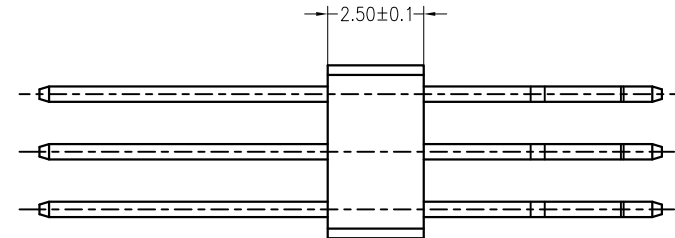

<b>JKUN</b> 温州健坤接插件有限公司 WENZHOU JKUN CONNECTOR CO.,LTD.		TITLE: 1.5mmpitch 90°Wafe SMT type	
GENERAL TOLERANCE		USE: CUSTOMER	PART NO.:
X. $\pm 0.50$	X. $\pm 5^{\circ}$	APPD: J. J. Yao	L1501AWR-203-F6MB2-R-4
X.X $\pm 0.30$	X.X $\pm 2^{\circ}$	CHKD: X. F. Yan	DWG NO.:
X.XX $\pm 0.20$	X.XX $\pm 1^{\circ}$	DR: J. Y. Jiang	SCALE 1 : 1
UNITS: mm		SHEET 1 / 1	

REV	DESCRIPTION	DESIGN	DATE
A0	NEW RELEASE	ChenZhiMing	2021/03/15

PIN.	DIM A	DIM B
2*2	1.50	3.00
2*3	3.00	4.50
2*4	4.50	6.00
2*5	6.00	7.50
2*6	7.50	9.00
2*7	9.00	10.50
2*8	10.50	12.00

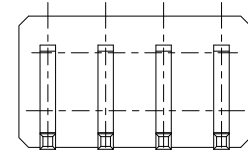
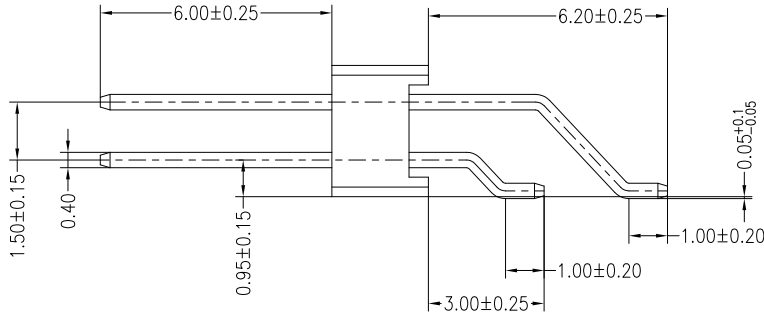
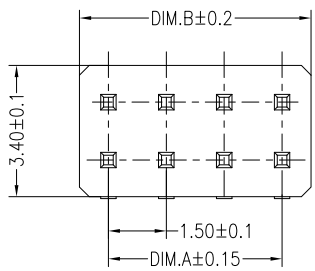

**Specifications:**

- Poles: 04 to 16
- Contact resistance: ≤30mΩ
- Insulation resistance: ≥500MΩ
- Rated voltage: 250V AC DC
- Rated current: 1.0A AC DC
- Withstand Voltage: 500V AC/minute
- Temperature Range: -40°C ~ +110°C
- Housing: LCP UL94V-0, Natural (Beige)
- Contacts: Brass/Matte Sn-plated

**ORDER INFORMATION:**

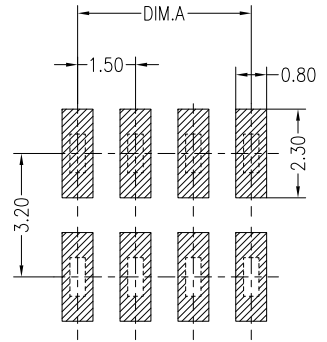
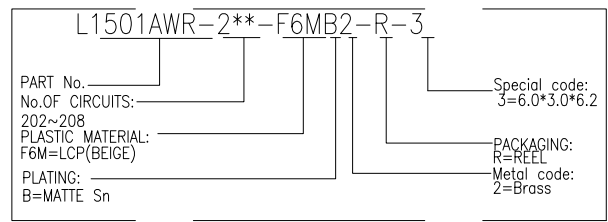

**ROMMENDED PCB LAYOUT**  
TOLERANCE ±0.05

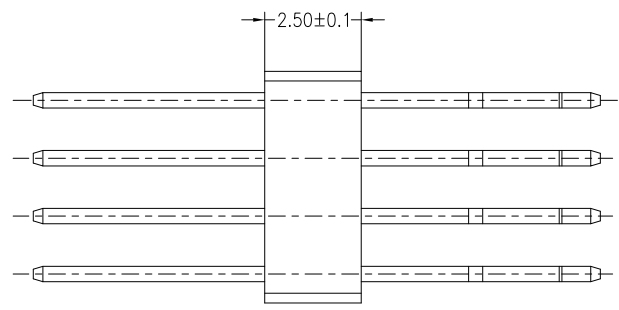

<b>JKUN</b> 温州健坤接插件有限公司 WENZHOU JKUN CONNECTOR CO.,LTD.		TITLE: 1.5mmpitch 90°Wafe SMT type	
GENERAL TOLERANCE		USE: CUSTOMER	PART NO.:
X. ±0.50	X. ±5°	APPD: ZhangZhongYong	L1501AWR-2**-F6MB2-R-3
X.X ±0.30	X.X ±2°	CHKD: JiangJianYin	DWG NO.:
X.XX ±0.20	X.XX ±1°	DR: ChenZhiMing	JKUN-GCKH-2445
UNITS: mm		SCALE 1 : 1	SHEET 1 / 1

REV	DESCRIPTION	DESIGN	DATE
A0	NEW RELEASE	Jiangjanyin	2019/07/04

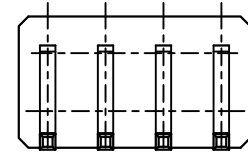
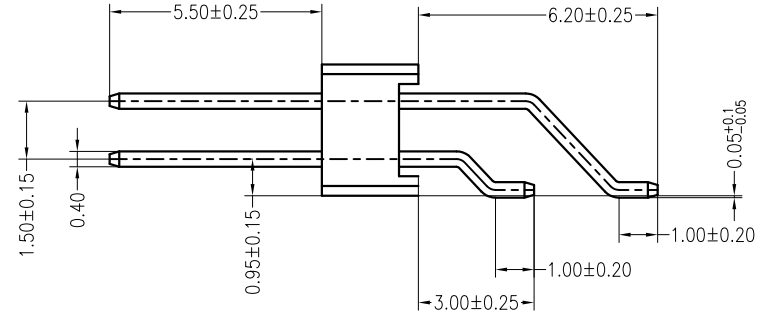
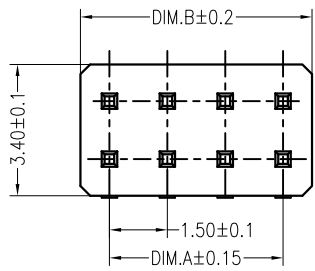

PIN.	DIM A	DIM B
2*2	1.50	3.00
2*3	3.00	4.50
2*4	4.50	6.00
2*5	6.00	7.50
2*6	7.50	9.00
2*7	9.00	10.50
2*8	10.50	12.00

**Specifications:**

- Poles: 04 to 16
- Contact resistance:  $\leq 30m\Omega$
- Insulation resistance:  $\geq 500M\Omega$
- Rated voltage: 250V AC DC
- Rated current: 1.0A AC DC
- Withstand Voltage: 500V AC/minute
- Temperature Range:  $-40^{\circ}C \sim +110^{\circ}C$
- Housing: LCP UL94V-0, Natural (Beige)
- Contacts: Brass/Matte Sn-plated

**ORDER INFORMATION:**

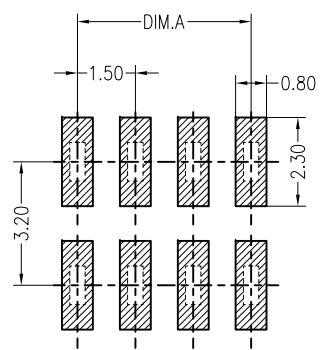
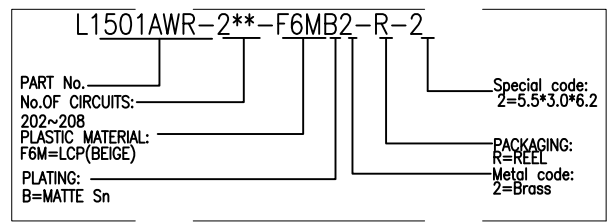

ROMMENDED PCB LAYOUT  
TOLERANCE  $\pm 0.05$

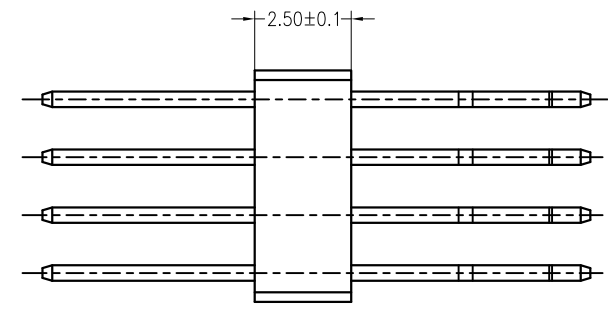

<b>JKUN</b> 温州健坤接插件有限公司 WENZHOU JKUN CONNECTOR CO.,LTD.		TITLE: 1.5mmpitch 90°Wafe SMT type	
GENERAL TOLERANCE		USE: CUSTOMER	PART NO.:
X. $\pm 0.50$	X. $\pm 5^{\circ}$	APPD: Liuzhenling	L1501AWR-2**-F6MB2-R-2
X.X $\pm 0.30$	X.X $\pm 2^{\circ}$	CHKD: Wangliang	DWG NO.:
X.XX $\pm 0.20$	X.XX $\pm 1^{\circ}$	DR: Jiangjanyin	JKUN-GCKH-1406
UNITS: mm		SCALE 1 : 1	SHEET 1 / 1

REV	ECN No.	DESCRIPTION	DESIGN	DATE
AO	-	Release	蒋建银	2018.10.30

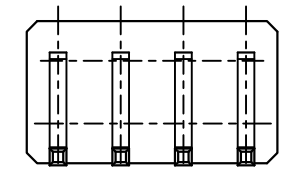
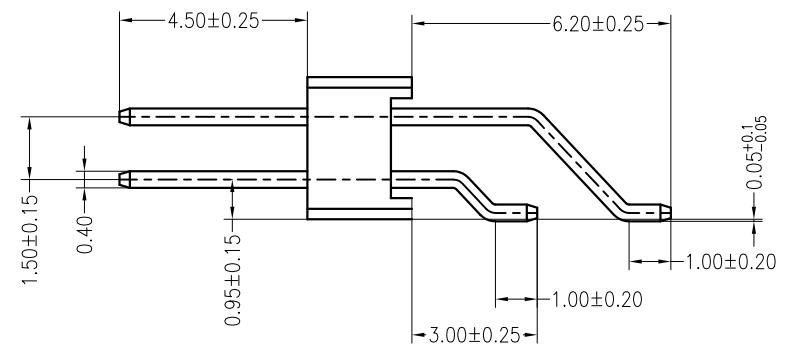
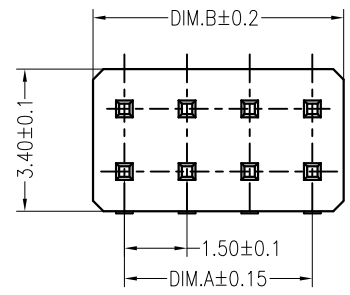

### 主要技术参数 Main Specifications

线 数 (Poles): 04 to 16  
 接触电阻 (Contact resistance):  $\leq 30m\Omega$   
 绝缘电阻 (Insulation resistance):  $\geq 500M\Omega$   
 额定电压 (Rated voltage): 250V AC DC  
 额定电流 (Rated current): 1.0A AC DC  
 耐 电 压 (Withstand Voltage): 500V AC/minute  
 温度范围 (Temperature Range):  $-40^{\circ}C \sim +110^{\circ}C$

### ORDER INFORMATION:

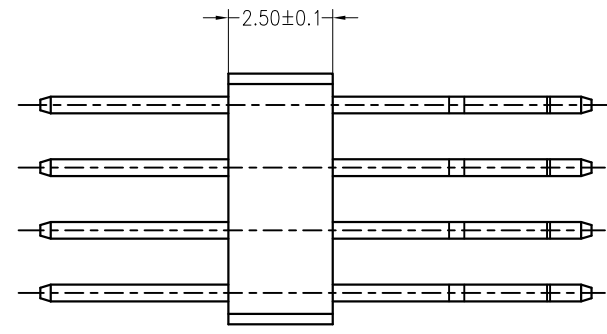
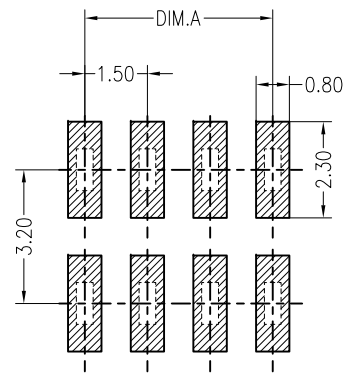
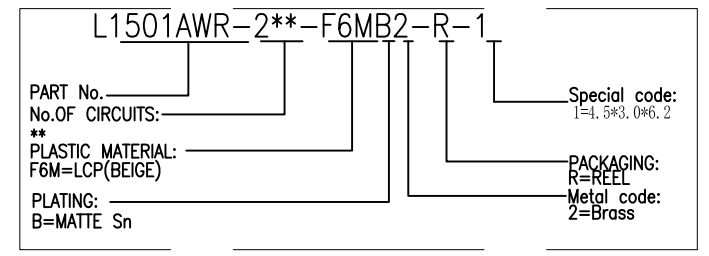

ROMMENDED PCB LAYOUT  
 TOLERANCE  $\pm 0.05$

PIN.	DIM A	DIM B
2*2	1.50	3.00
2*3	3.00	4.50
2*4	4.50	6.00
2*5	6.00	7.50
2*6	7.50	9.00
2*7	9.00	10.50
2*8	10.50	12.00

ITEM	COMPONENT	Q'TY	MATERIAL	FINISH
C				
B	CONTACT	n PCS	Brass	MATTE Sn-plated
A	HOUSING	1 PCS	LCP	UL 94V-0, COLOR:BEIGE

<b>JKUN</b> 温州健坤接插件有限公司 WENZHOU JKUN CONNECTOR CO., LTD.		TITLE: - -	
X.±0.5	X.±5'	USE:	PART NO.:
.X±0.3	.X±2'	CUSTOMER	L1501AWR-2**-F6MB2-R-1
.XX±0.25	.XX±1'	APPD:	DWG NO.:
--	--	刘振岭	JKUN-GCCP-1248
		CHKD:	SCALE
		王亮	1 : 1
		DR:	SHEET
		蒋建银	1 / 1

REV	DESCRIPTION	DESIGN	DATE
A	NEW RELEASE	宋鹏翔	2023/12/14

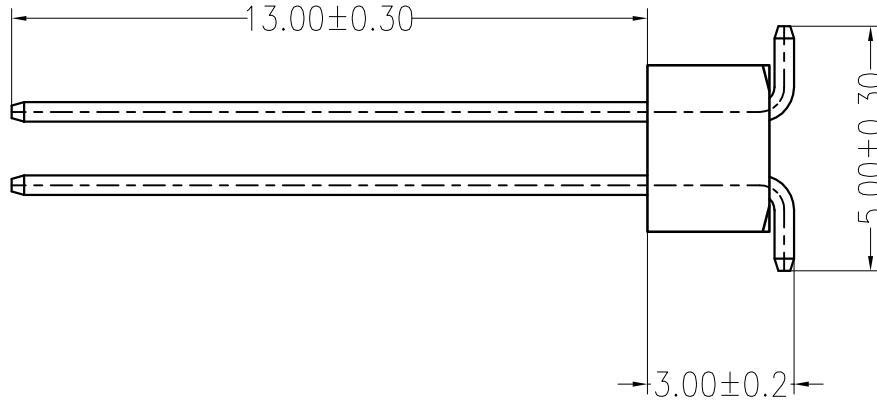
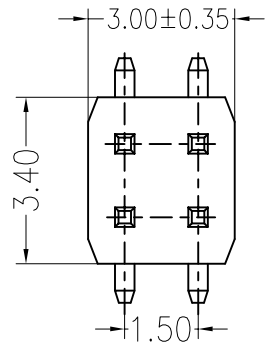

**Specifications:**

- Contact resistance:  $\leq 20\text{m}\Omega$
- Insulation resistance:  $\geq 1000\text{M}\Omega$
- Rated current: 1.0A AC DC
- Withstand Voltage: 500V AC/minute
- Temperature Range:  $-40^{\circ}\text{C} \sim +105^{\circ}\text{C}$
- Housing: LCP UL94V-0, Natural (Beige)
- Contacts: Brass/Matte Sn

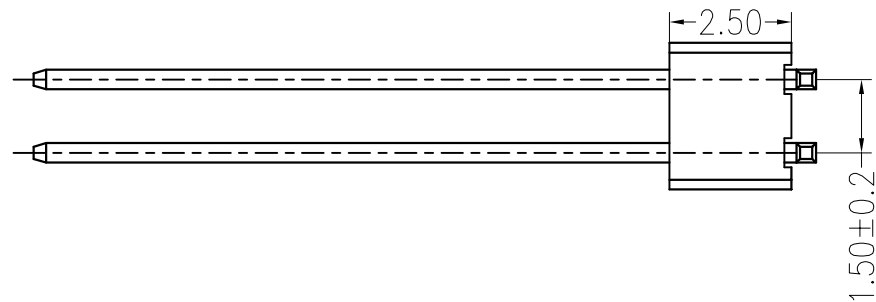

**ORDER INFORMATION:**

<b>L1501AWV-202-F6MB2-P-8</b>	
PART No. _____	Special code: 8=13.0*3.0*5.0
No.OF CIRCUITS: _____	PACKAGING: P=PE
2*2	Metal code: 2=Brass
PLASTIC MATERIAL: _____	PLATING: B=Matte Sn
F6M=LCP(BEIGE)	

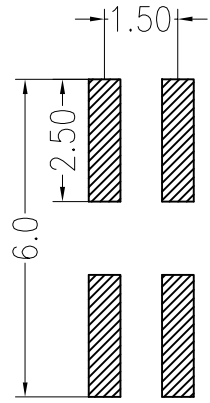

**P. C. B. LAYOUT**

<b>JKUN 温州健坤接插件有限公司</b> WENZHOU JKUN CONNECTOR CO.,LTD.		TITLE: -	
GENERAL TOLERANCE		USE: CUSTOMER	PART NO.: L1501AWV-202-F6MB2-P-8
X.X ±0.30	X. ±5'	APPD: 姚建军	DWG NO.: JKUN-GCKH-2668
X.XX ±0.20	X.X ±2'	CHKD: 颜鹏	SCALE: 1 : 1
X.XXX ±0.10	X.XX ±1'	DR: 宋鹏翔	SHEET: 1 / 1
⊕	UNITS: mm		

REV	DESCRIPTION	DESIGN	DATE
A	NEW RELEASE	蒋建银	2023/03/10

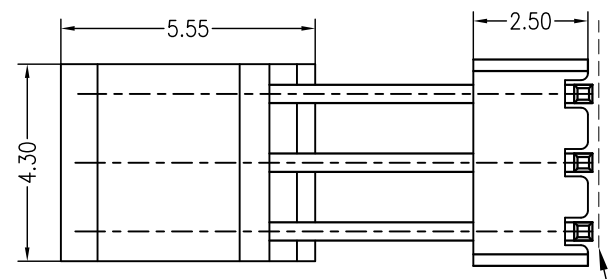
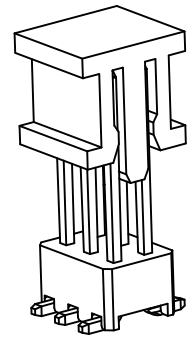
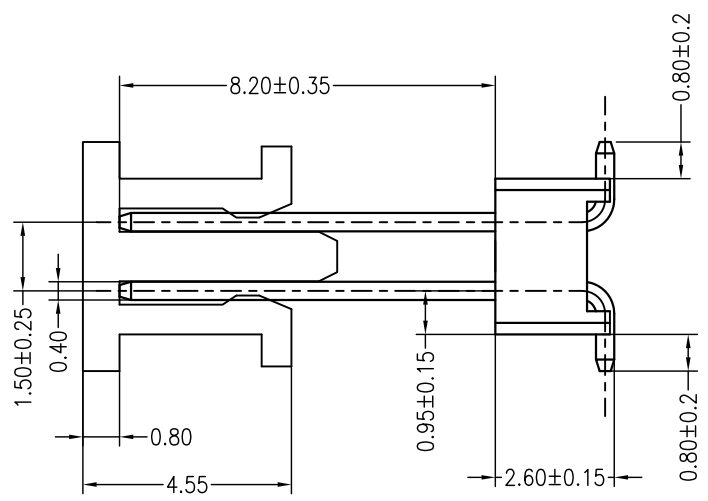
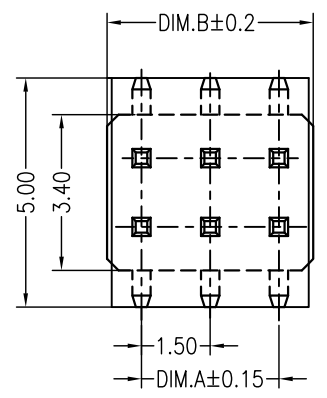

0.1 MAX

**Specifications:**

Poles: 04 to 16  
 Contact resistance: ≤30mΩ  
 Insulation resistance: ≥500MΩ  
 Rated voltage: 250V AC DC  
 Rated current: 1.0A AC DC  
 Withstand Voltage: 500V AC/minute  
 Temperature Range: -40°C ~ +110°C  
 Housing: LCP UL94V-0, Natural(Beige)  
 Contacts: Brass/Matte Sn-plated  
 Cap: LCP UL94V-0, Natural(Beige)

**ORDER INFORMATION:**

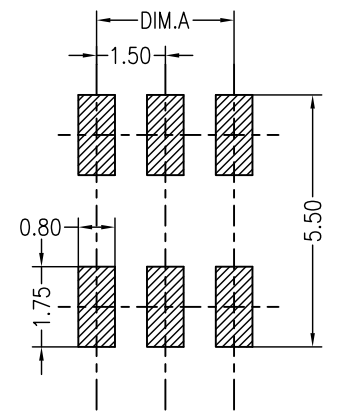
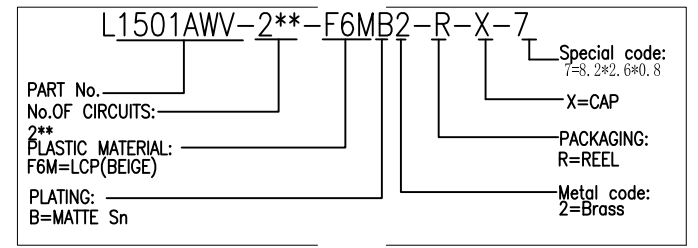

Board Layout

General Tolerance: ±0.05

PIN.	DIM A	DIM B
2*2	1.50	3.00
2*3	3.00	4.50
2*4	4.50	6.00
2*5	6.00	7.50
2*6	7.50	9.00
2*7	9.00	10.50
2*8	10.50	12.00

<b>JKUN</b> 温州健坤接插件有限公司 WENZHOU JKUN CONNECTOR CO.,LTD.		TITLE: ***	
GENERAL TOLERANCE		USE: CUSTOMER	PART NO.:
X. ±0.50	X. ±5'	APPD: 朱志刚	L1501AWV-2**-F6MB2-R-X-7
X.X ±0.30	X.X ±2'		DWG NO.:
X.XX ±0.20	X.XX ±1'	CHKD: 颜鹏	JKUN-GCKH-2591
UNITS: mm	DR: 蒋建银	SCALE	SHEET
		1 : 1	1 / 1

REV	DESIGN	DATE
A0	蒋建银	2019.02.28
-	-	-

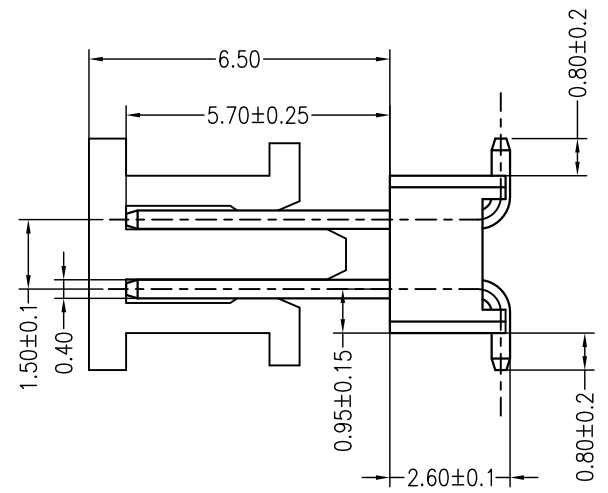
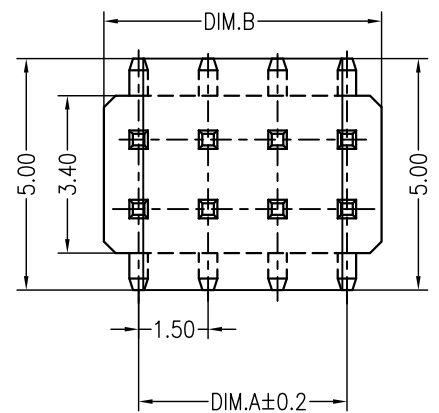

### 主要技术参数 Main Specifications

- 线数 (Poles): 04 to 16
- 接触电阻 (Contact resistance):  $\leq 30m\Omega$
- 绝缘电阻 (Insulation resistance):  $\geq 500M\Omega$
- 额定电压 (Rated voltage): 250V AC DC
- 额定电流 (Rated current): 1.0A AC DC
- 耐电压 (Withstand Voltage): 500V AC/minute
- 温度范围 (Temperature Range):  $-40^{\circ}C \sim +110^{\circ}C$

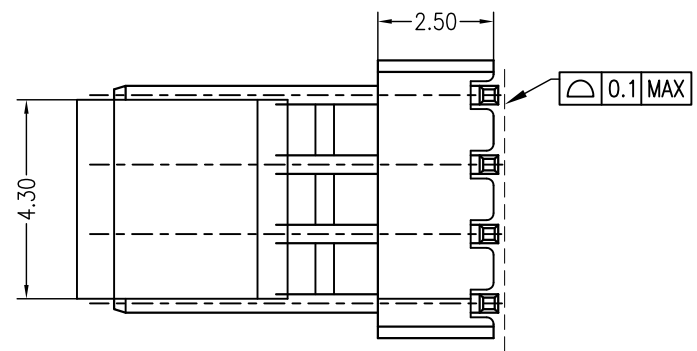
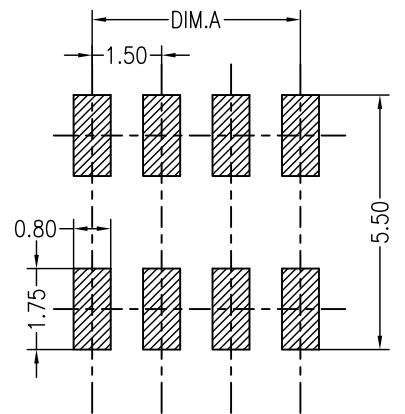

### ORDER INFORMATION:

**L1501AWV-2\*\*-F6MB2-R-6**

PART No.:	Special code:
No.OF CIRCUITS:	6=5, 7*0, 8
2*2~2*8	PACKAGING:
PLASTIC MATERIAL:	R=REEL
F6M=LCP(BEIGE)	Metel code:
PLATING:	2=Brass
B=MATTE Sn	

Board Layout  
General Tolerance:  $\pm 0.05$

PIN.	DIM A	DIM B	ITEM	COMPONENT	Q'TY	MATERIAL	FINISH	
2*2	1.50	3.00	C	CAP	1 PCS	LCP	UL 94V-0, COLOR:BEIGE	
			B	CONTACT	** PCS	Brass	MATTE Sn-plated	
2*3	3.00	4.50	A	HOUSING	1 PCS	LCP	UL 94V-0, COLOR:BEIGE	
			<b>JKUN 温州健坤接插件有限公司</b> <b>WENZHOU JKUN CONNECTOR CO.,LTD.</b>					
2*4	4.50	6.00	X. $\pm 0.5$ X. $\pm 5^*$ USE: CUSTOMER APPD: 邵敬和 CHKD: 曾令青				TITLE: -	
2*5	6.00	7.50	.X. $\pm 0.3$ .X. $\pm 2^*$ .XX. $\pm 0.25$ .XX. $\pm 1^*$				PART NO.:	L1501AWV-2**-F6MB2-R-6
2*6	7.50	9.00	DR: 蒋建银				DWG NO.:	JKUN-GCKH-2474
2*7	9.00	10.50	UNITS: mm				SCALE	1 : 1
2*8	10.50	12.00					SHEET	1 / 1

REV	DESCRIPTION	DESIGN	DATE
A	NEW RELEASE	蒋建银	2021/11/27

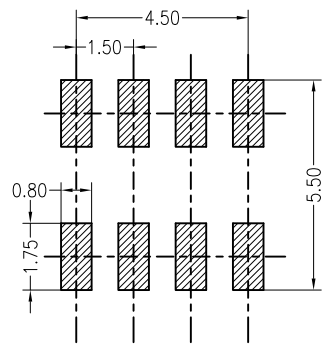
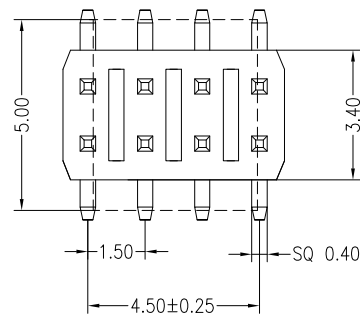

Board Layout  
General Tolerance: ±0.05

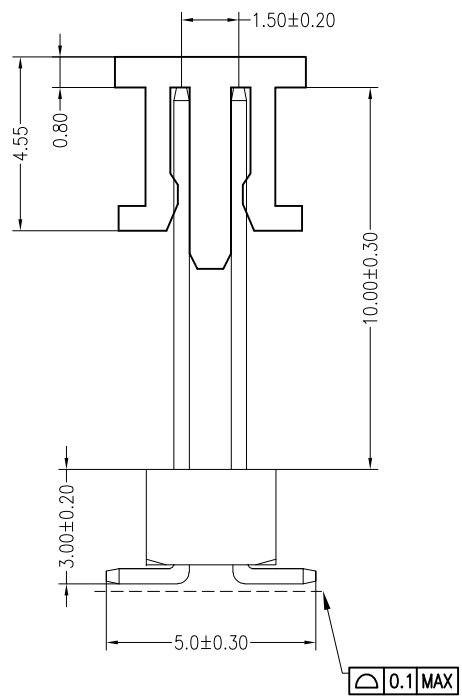
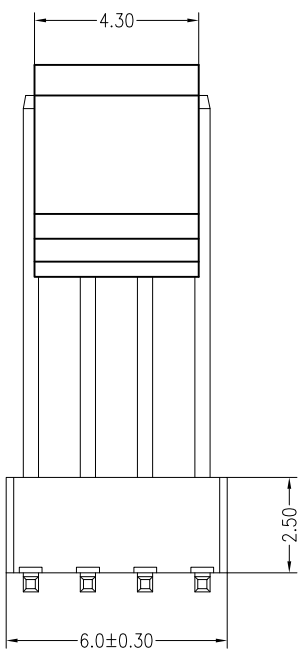

0.1 MAX

**Specifications:**

- Poles: 04 to 16
- Contact resistance: ≤30mΩ
- Insulation resistance: ≥500MΩ
- Rated voltage: 250V AC DC
- Rated current: 1.0A AC DC
- Withstand Voltage: 500V AC/minute
- Temperature Range: -40°C ~ +110°C
- Housing: LCP UL94V-0, Natural (Beige)
- Contacts: Brass/Matte Sn-plated
- Cap: LCP UL94V-0, Natural (Beige)

**ORDER INFORMATION:**

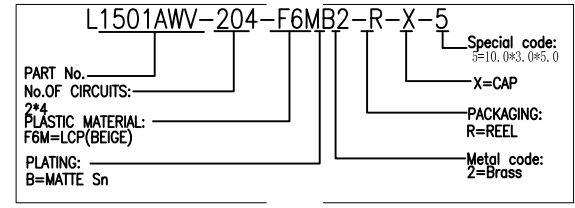

<b>JKUN</b> 温州健坤接插件有限公司 WENZHOU JKUN CONNECTOR CO.,LTD.		TITLE: ***	
GENERAL TOLERANCE		USE: CUSTOMER	PART NO.:
X. ±0.50	X. ±5°	APPD: 邵敬和	L1501AWV-204-F6MB2-R-X-5
X.X ±0.30	X.X ±2°	CHKD: 曾令青	DWG NO.:
X.XX ±0.20	X.XX ±1°	DR: 蒋建银	JKUN-GCKH-2405
UNITS: mm		SCALE 1 : 1	SHEET 1 / 1

REV	DESCRIPTION	DESIGN	DATE
A0	NEW RELEASE	蒋建银	2019/10/26

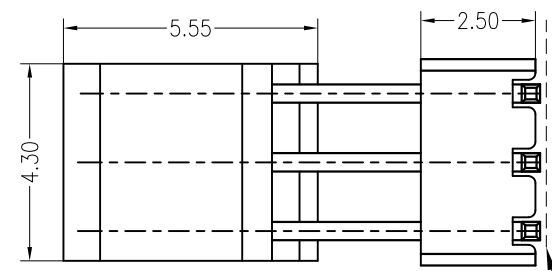
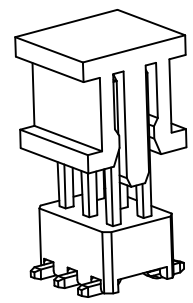
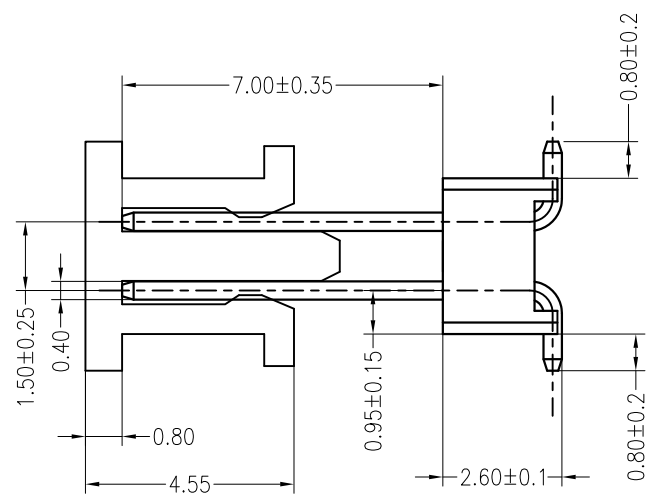
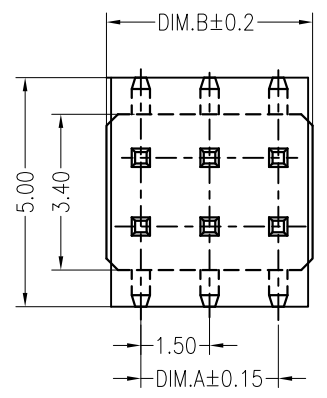

0.1 MAX

**Specifications:**

- Poles: 04 to 16
- Contact resistance:  $\leq 30m\Omega$
- Insulation resistance:  $\geq 500M\Omega$
- Rated voltage: 250V AC DC
- Rated current: 1.0A AC DC
- Withstand Voltage: 500V AC/minute
- Temperature Range:  $-40^{\circ}C \sim +110^{\circ}C$
- Housing: LCP UL94V-0, Natural(Beige)
- Contacts: Brass/Matte Sn-plated
- Cap: LCP UL94V-0, Natural(Beige)

**ORDER INFORMATION:**

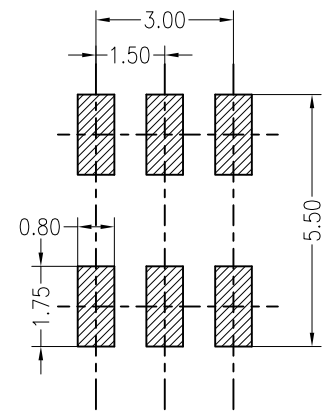
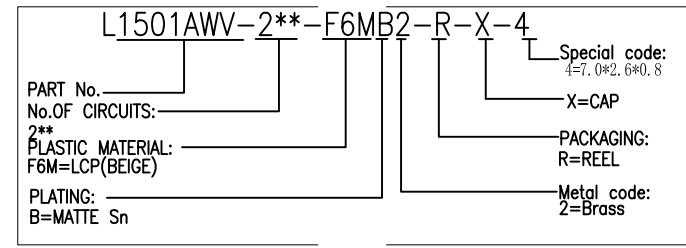

Board Layout

General Tolerance:  $\pm 0.05$

PIN.	DIM A	DIM B
2*2	1.50	3.00
2*3	3.00	4.50
2*4	4.50	6.00
2*5	6.00	7.50
2*6	7.50	9.00
2*7	9.00	10.50
2*8	10.50	12.00

JKUN 温州健坤接插件有限公司 WENZHOU JKUN CONNECTOR CO.,LTD.			TITLE: ***	
GENERAL TOLERANCE		USE:	PART NO.:	
X. $\pm 0.50$	X. $\pm 5^{\circ}$	CUSTOMER	L1501AWV-2**-F6MB2-R-X-4	
X.X $\pm 0.30$	X.X $\pm 2^{\circ}$	APPD: 刘振岭	DWG NO.:	
X.XX $\pm 0.20$	X.XX $\pm 1^{\circ}$	CHKD: 王亮	JKUN-GCKH-1477	
UNITS: mm		DR: 蒋建银	SCALE	SHEET
			1 : 1	1 / 1

A B C D

E F

REV	ECN No.	DESCRIPTION	DESIGN	DATE
AO	-	Release	蒋建银	2018.12.27

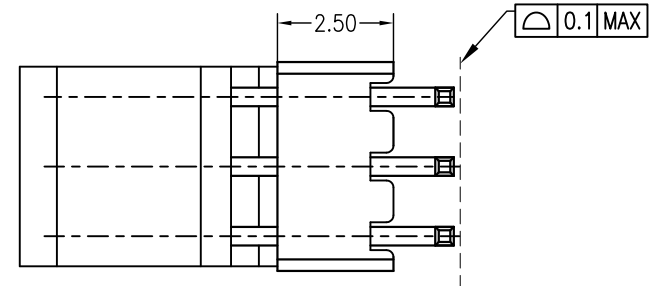
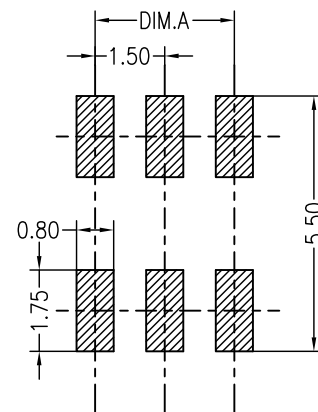
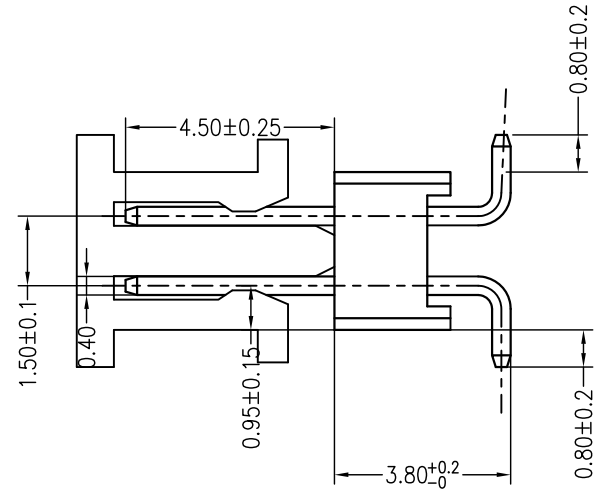
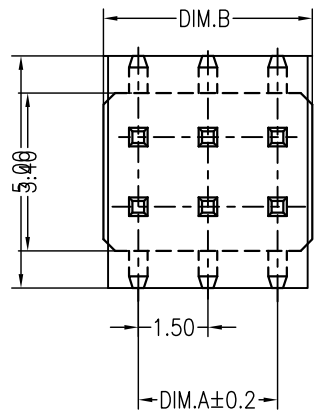

### 主要技术参数 Main Specifications

线 数 (Poles): 04 to 16  
 接触电阻 (Contact resistance):  $\leq 30m\Omega$   
 绝缘电阻 (Insulation resistance):  $\geq 500M\Omega$   
 额定电压 (Rated voltage): 250V AC DC  
 额定电流 (Rated current): 1.0A AC DC  
 耐 电压 (Withstand Voltage): 500V AC/minute  
 温度范围 (Temperature Range):  $-40^{\circ}C \sim +110^{\circ}C$

### ORDER INFORMATION:

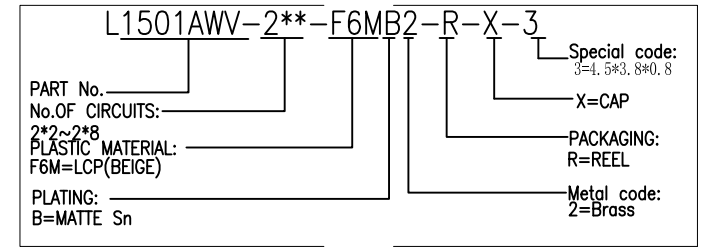

Board Layout  
General Tolerance:  $\pm 0.05$

PIN.	DIM A	DIM B
2*2	1.50	3.00
2*3	3.00	4.50
2*4	4.50	6.00
2*5	6.00	7.50
2*6	7.50	9.00
2*7	9.00	10.50
2*8	10.50	12.00

ITEM	COMPONENT	Q'TY	MATERIAL	FINISH
C	CAP	1 PCS	LCP	UL 94V-0, COLOR:BEIGE
B	CONTACT	** PCS	Brass	MATTE Sn-plated
A	HOUSING	1 PCS	LCP	UL 94V-0, COLOR:BEIGE

  

<b>JKUN</b> 温州健坤接插件有限公司 WENZHOU JKUN CONNECTOR CO., LTD.		TITLE: -	
X.±0.5	X.±5'	USE: CUSTOMER	PART NO.: L1501AWV-2**-F6MB2-R-X-3
.X±0.3	.X±2'		
.XX±0.25	.XX±1'	APPD: 邵敬和	DWG NO.: JKUN-GCCP-1293
--	--	CHKD: 田峰	SCALE: 1 : 1
UNITS: mm		DR: 蒋建银	SHEET: 1 / 1

A B C D

E F

REV	DESIGN	DATE
A0	蒋建银	2019.02.28
-	-	-

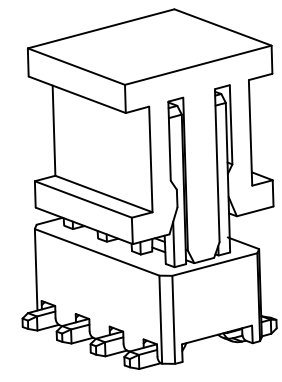
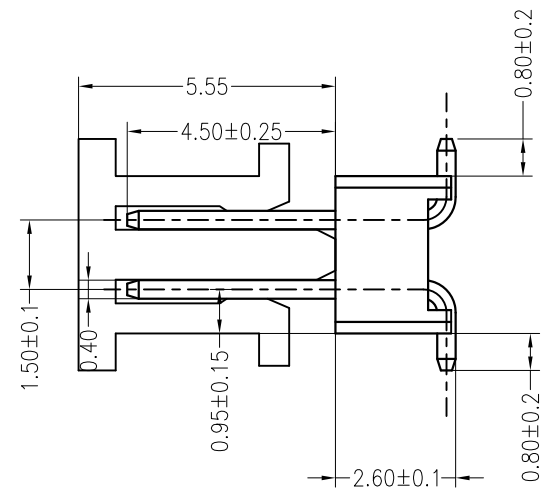
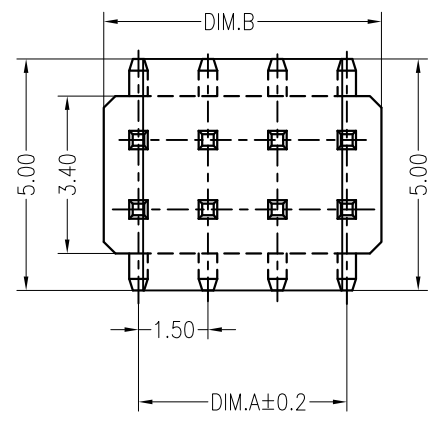

### 主要技术参数 Main Specifications

- 线数 (Poles): 04 to 16
- 接触电阻 (Contact resistance):  $\leq 30m\Omega$
- 绝缘电阻 (Insulation resistance):  $\geq 500M\Omega$
- 额定电压 (Rated voltage): 250V AC DC
- 额定电流 (Rated current): 1.0A AC DC
- 耐电压 (Withstand Voltage): 500V AC/minute
- 温度范围 (Temperature Range):  $-40^{\circ}C \sim +110^{\circ}C$

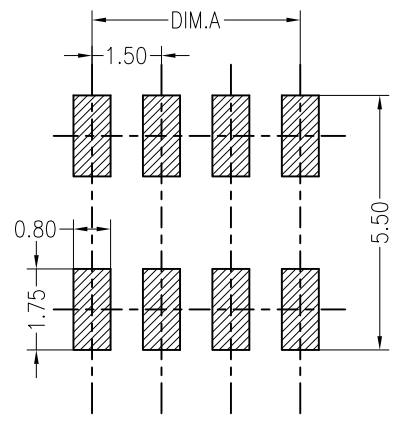

Board Layout

General Tolerance:  $\pm 0.05$

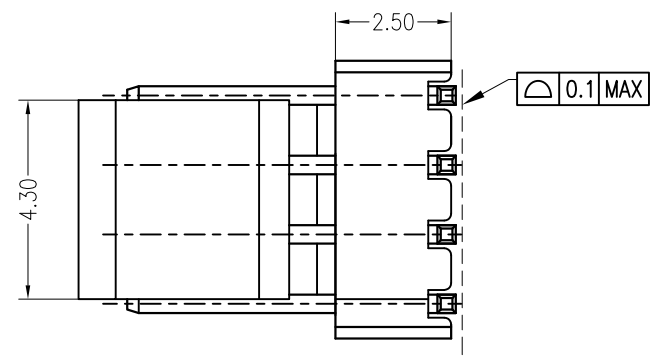

### ORDER INFORMATION:

**L1501AWV-2\*\*-F6MB2-R-2**

PART No.:		Special code:	
No.OF CIRCUITS:		2=4.5*0.8	
2*2~2*8		PACKAGING:	
PLASTIC MATERIAL:		R=REEL	
F6M=LCP(BEIGE)		Metal code:	
PLATING:		2=Brass	
B=MATTE Sn			

PIN.	DIM A	DIM B	ITEM	COMPONENT	Q'TY	MATERIAL	FINISH	
2*2	1.50	3.00	C	CAP	1 PCS	LCP	UL 94V-0, COLOR:BEIGE	
			B	CONTACT	** PCS	Brass	MATTE Sn-plated	
2*3	3.00	4.50	A	HOUSING	1 PCS	LCP	UL 94V-0, COLOR:BEIGE	
2*4	4.50	6.00	<b>JKUN 温州健坤接插件有限公司</b> <b>WENZHOU JKUN CONNECTOR CO.,LTD.</b>				TITLE: -	
2*5	6.00	7.50					PART NO.:	
2*6	7.50	9.00	X.±0.5	X.±5'	USE:	CUSTOMER		
2*7	9.00	10.50	.X±0.3	.X±2'	APPD:			DWG NO.:
2*8	10.50	12.00	.XX±0.25	.XX±1'	CHKD:	JKUN-GCKH-1253		
			---	---	DR:	SCALE	SHEET	
			⊕	UNITS: mm	蒋建银	1 : 1	1 / 1	

REV	ECN No.	DESCRIPTION	DESIGN	DATE
A0	-	Release	-	2018.06.11

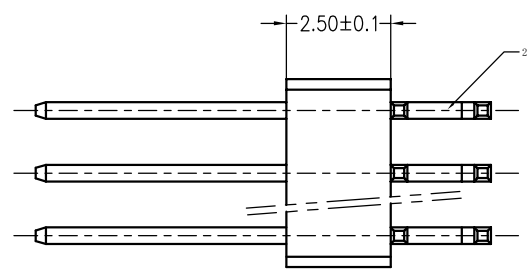
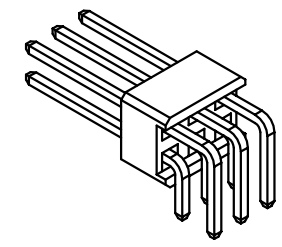
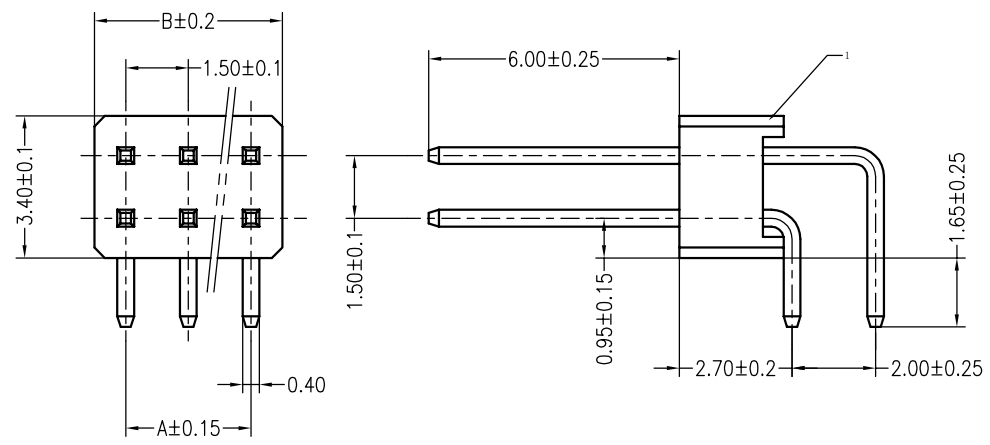

### 主要技术参数 Main Specifications

- 线数 (Poles): 04 to 16
- 接触电阻 (Contact resistance):  $\leq 30m\Omega$
- 绝缘电阻 (Insulation resistance):  $\geq 500M\Omega$
- 额定电压 (Rated voltage): 250V AC DC
- 额定电流 (Rated current): 1.0A AC DC
- 耐电压 (Withstand Voltage): 500V AC/minute
- 温度范围 (Temperature Range):  $-40^{\circ}C \sim +110^{\circ}C$

ORDER INFORMATION:

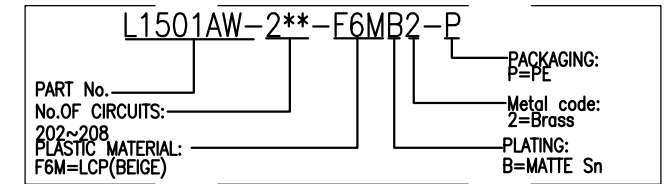

PIN.	DIM A	DIM B
2*2	1.50	3.00
2*3	3.00	4.50
2*4	4.50	6.00
2*5	6.00	7.50
2*6	7.50	9.00
2*7	9.00	10.50
2*8	10.50	12.00

### PCB LAYOUT

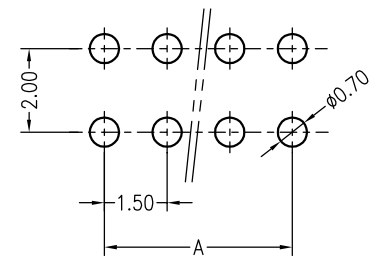

ITEM	COMPONENT	Q'TY	MATERIAL	FINISH
C				
B	CONTACT	4~16 PCS	Brass	MATTE Sn-plated
A	HOUSING	1 PCS	LCP	UL 94V-0, COLOR:BEIGE

<b>JKUN 温州健坤接插件有限公司</b> <b>WENZHOU JKUN CONNECTOR CO., LTD.</b>			TITLE: -	
X.±0.5	X.±5'	USE: CUSTOMER	PART NO.:	
.X±0.3	.X±2'		L1501AW-2**-F6MB2-P	
.XX±0.25	.XX±1'		DWG NO.:	
--	--	CHKD: 田峰	JKUN-GCCP-1173	
⊕	◁	UNITS: mm	DR: 蒋建银	SCALE: 1:1
			SHEET 1 / 1	

REV	ECN No.	DESCRIPTION	DESIGN	DATE
A0	-	Release	蒋建银	2018.10.13

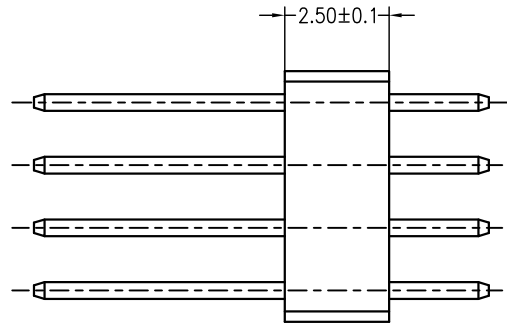
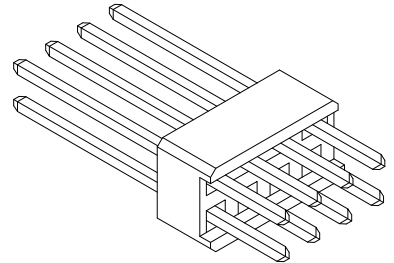
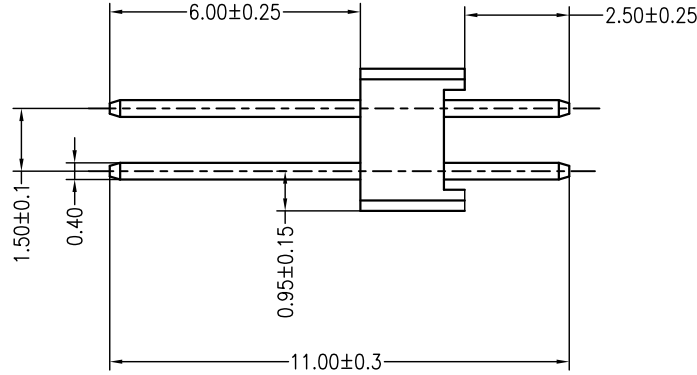
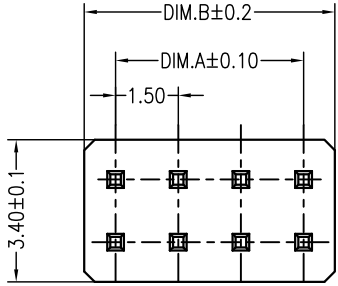

### 主要技术参数 Main Specifications

线 数 (Poles): 04 to 16  
 接触电阻 (Contact resistance):  $\leq 30m\Omega$   
 绝缘电阻 (Insulation resistance):  $\geq 500M\Omega$   
 额定电压 (Rated voltage): 250V AC DC  
 额定电流 (Rated current): 1.0A AC DC  
 耐 电压 (Withstand Voltage): 500V AC/minute  
 温度范围 (Temperature Range):  $-40^{\circ}C \sim +110^{\circ}C$

### ORDER INFORMATION:

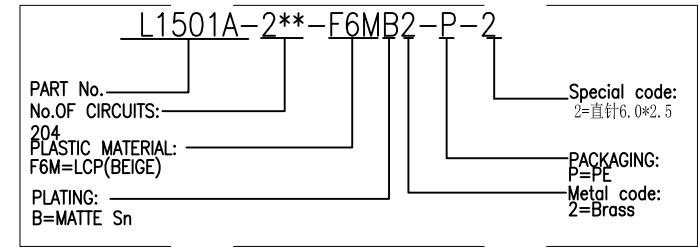

PIN.	DIM A	DIM B
2*2	1.50	3.00
2*3	3.00	4.50
2*4	4.50	6.00
2*5	6.00	7.50
2*6	7.50	9.00
2*7	9.00	10.50
2*8	10.50	12.00

### PCB LAYOUT

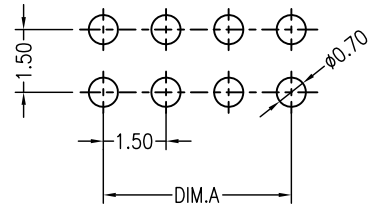

ITEM	COMPONENT	Q'TY	MATERIAL	FINISH
C				
B	CONTACT	n PCS	Brass	MATTE Sn-plated
A	HOUSING	1 PCS	LCP	UL 94V-0, COLOR:BEIGE

<b>JKUN</b> 温州健坤接插件有限公司 WENZHOU JKUN CONNECTOR CO., LTD.			TITLE: - -	
X.±0.5	X.±5'	USE: CUSTOMER APPD: 邵敬和 CHKD: 田峰	PART NO.: L1501A-2**-F6MB2-P-2	
.X±0.3	.X±2'		DWG NO.: JKUN-GCCP-1233	
.XX±0.25	.XX±1'	DR: 蒋建银	SCALE 1 : 1	
⊕	⊖		SHEET 1 / 1	